

# THE SMART ALTERNATIVE TO VINYL



BEAUTIFUL • COLORFUL • DURABLE

# A BETTER CHOICE FOR YOUR HOME.

Whether you're replacing, remodeling or building, now you can bring Andersen beauty, craftsmanship and time-tested performance into your home for less than you may expect. Andersen® 100 Series windows and patio doors are made with our revolutionary Fibrex® composite material, which allows us to offer an uncommon value others can't. It's environmentally responsible and energy efficient, and it comes in durable colors that are darker and richer than most vinyl windows.

**FIBREX®**  
MATERIAL IS  
**2X**  
STRONGER  
THAN VINYL

## LONG-LASTING\* STRENGTH



Durable 100 Series products come with factory-finished interiors and exteriors that never need painting and won't fade, flake, blister or peel.\*





**COLORS THAT  
LAST\***

Andersen® 100 Series windows come in beautiful, dark colors that will set your home apart.



Deep, rich colors, including Cocoa Bean, Dark Bronze and Black, complement virtually any architectural style.

## **MADE POSSIBLE BY OUR EXCLUSIVE FIBREX® MATERIAL**

Fibrex® material is more than just environmentally responsible. It's also durable and beautiful. Here's what helps make Fibrex material so revolutionary:

- Fibrex material is **twice as strong as vinyl**, so weathertight seals stay weathertight.
- Our unique fabrication process **blends the color with the Fibrex material** for long-lasting beauty.
- It blocks thermal transfer nearly 700 times better than aluminum to help **reduce heating and cooling bills**.
- For **exceptional durability**, Fibrex material retains its stability and rigidity in all climates.



**ENVIRONMENTALLY  
SMART**

100 Series products are made with our Fibrex composite material. It's composed of 40% reclaimed wood fiber by weight, most of which is created during the manufacture of Andersen wood windows.



**40%**  
**reclaimed wood fiber**  
by weight.



Learn more about Fibrex material by watching our video at [andersenwindows.com/fibrex](http://andersenwindows.com/fibrex)

# WHY ANDERSEN® 100 SERIES WINDOWS & DOORS ARE AN EASY CHOICE.

All 100 Series windows and patio doors feature the performance, durability and ease of use you've come to expect from Andersen. Which means they not only provide energy efficiency, beauty and reliability today, but they'll also continue to add value to your home tomorrow and for years\* to come. **Plus, they're virtually maintenance free.**



## REPLACEMENT

If you're thinking of replacement, think of 100 Series windows and patio doors. You'll find choices for virtually any project, and all feature energy-efficient designs that help keep energy bills to a minimum.



**Custom sizes for a weathertight fit.**

100 Series windows and patio doors are available in custom sizes, which helps provide a more weathertight fit for any replacement project.

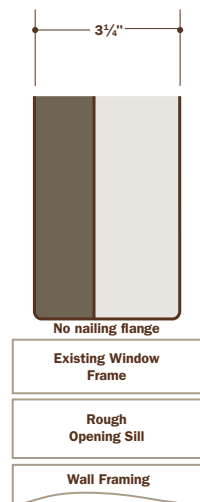

### Replacement Configuration

This frame allows for fast and easy window replacement. Install the window into your existing window frame without disturbing interior or exterior trim, which saves you time and money.

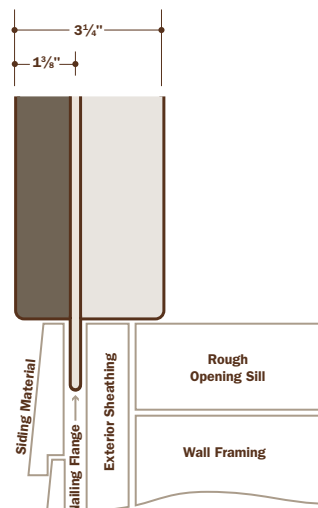

### 1 3/8" Flange Setback

The integral nailing flange makes it easy to install windows into a new opening and helps make sure the windows and doors are weathertight.

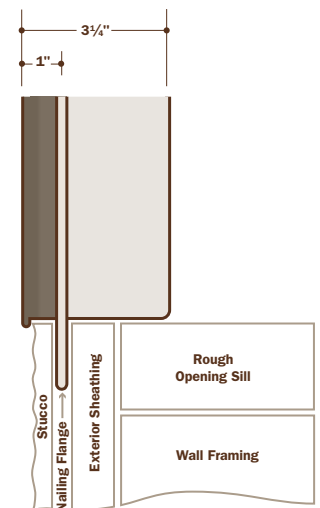

### 1" Flange Setback with Stucco Key

The integral nailing flange makes it easy to install windows into a new opening and helps make sure the windows and doors are weathertight. The stucco key eliminates gaps that can result from the natural contraction of exterior stucco.

# ENVIRONMENTALLY SMART



## Save money by saving energy.

Andersen® 100 Series products are available with glass options\* that make them ENERGY STAR® certified, helping to **lower your heating and cooling bills**. What's more, the Fibrex® material used for 100 Series frames and sash blocks thermal transfer nearly 700 times better than aluminum.

## It pays to understand performance.

Look for the National Fenestration Rating Council® (NFRC) performance information. It's your assurance you're getting accurate energy performance ratings from a nonpartisan, nonprofit organization. Here's what the numbers mean:

**U-Factor** measures the window's insulating capability. The lower the value, the less heat is lost through the entire product.

**Visible Transmittance** refers to how much visible light comes through a product. The higher the number, the better the visibility.

**Solar Heat Gain Coefficient (SHGC)** measures how well a product blocks heat from the sun. The lower the number, the more it helps reduce air conditioning bills.

Visit [andersenwindows.com/100series](http://andersenwindows.com/100series) for details.

# STRENGTH

## Easy operation for years to come.\*\*

All 100 Series products are **tested to the extreme** to deliver years of smooth, reliable operation.\*\*

## Take comfort in superior weather resistance.

Our weather-resistant construction **seals out drafts, wind and water** so well, you can relax in comfort whatever the weather. We carefully select weatherstripping to match each style of window and door to make sure you enjoy superior comfort and reliability.

# OWNER2OWNER<sup>®</sup> LIMITED WARRANTY

## Quality so solid, the warranty is transferable.\*\*

Most other window and door warranties end when a home is sold, but our coverage — 20 years on glass, 10 years on non-glass parts — transfers from each homeowner to the next. And, because it's not prorated, the coverage offers **full benefits, year after year, owner after owner**. So it can add real value when you decide to sell your home.

## Never needs painting.

100 Series windows and doors **won't fade, flake, blister or peel,\*\*** no matter what the climate.

# BEAUTY

## Virtually seamless corners.

To give your windows, patio doors and your home a beautiful, clean look, Andersen 100 Series products feature virtually seamless corners.



100 Series corner seam



Welded vinyl corner seam



## Six colors for beautiful curb appeal.

From White and Sandtone to deep, rich Terratone, Cocoa Bean, Dark Bronze and Black colors, 100 Series windows and doors complement any home and any replacement project.

## Improve your view with TruScene<sup>®</sup> insect screens.

With **over 50% more clarity** than conventional insect screens, optional TruScene<sup>®</sup> insect screens give you beautifully unobstructed views. They let more sunlight and fresh air into your home while keeping some of the smallest insects out.†

\*Excludes units with capillary breather tubes. See your dealer for details.

\*\*Visit [andersenwindows.com/warranty](http://andersenwindows.com/warranty) for details.

†All comparisons made to conventional Andersen<sup>®</sup> insect screens.

# CHOOSE THE WINDOWS, DOORS & OPTIONS THAT ARE RIGHT FOR YOU.

## WINDOW & DOOR TYPES

Building an energy-efficient home doesn't mean you have to restrict your dreaming. Andersen® 100 Series windows and doors come in styles, shapes and even custom sizes to create the look you want.



### SINGLE-HUNG WINDOWS

This style features a stationary upper sash that is also available with an arched top to enhance the look of your home.



### CASEMENT & AWNING WINDOWS

Both styles open with a simple turn of a handle and can also be ordered as stationary windows.



### GLIDING WINDOWS

These windows have one stationary sash and one that opens. A three-sash configuration, where two sash glide past a fixed center sash, is also available.



### GLIDING PATIO DOORS

Patio doors feature one stationary panel and one that glides smoothly on adjustable rollers. They feature a multi-point locking system for enhanced security, and an optional exterior keyed lock for convenience. For more character, consider adding 100 Series sidelight windows on each side of your door and a transom window on top.



### PICTURE & SPECIALTY WINDOWS

Arch, Springline™, half circle, quarter circle, full circle, and rectangle shapes are available to complement your home's architecture. New additional shapes include: angled pentagon, peak pentagon, right triangle, isosceles triangle, octagon, trapezoid and unequal leg arch.



Available in custom sizes to fit all projects, including replacement.

## GLASS

Choose the right glass to maximize performance.

### SMARTSUN™ GLASS

Low-E SmartSun™ glass is the most energy-efficient glass we have ever offered. It rejects unwanted solar heat to help reduce cooling costs and blocks 95% of UV rays that can cause your home furnishings to fade — all while providing a clear view.

### LOW-E GLASS

Energy-efficient Low-E glass is available on all 100 Series products, and can help reduce energy bills in any climate.

### HEATLOCK™ TECHNOLOGY

Our HeatLock™ coating can increase the energy efficiency of any 100 Series window or patio door with Low-E or SmartSun glass. Applied to the room-side glass surface, it reflects heat back into the home and improves U-Factors, which can help the window or door meet ENERGY STAR® requirements.

### DUAL-PANE GLASS

Dual-pane glass is available for projects where codes allow its use.

### SOUND-REDUCING GLASS

This glass option helps reduce the volume of outside noise. Available with Low-E, SmartSun and HeatLock coatings.

### PATTERNED GLASS

Our patterned glass is ideal in bathrooms, entryways, offices and other areas where you want to let light into your home while obscuring the vision of people outside. It delivers all the benefits of Low-E glass and can also be ordered with Low-E SmartSun glass.



Obscure



Cascade



Reed



Fern



# GRILLES

Customize the look of your windows and doors with these grille options.

**Finelight™ grilles-between-the-glass** make glass easy to clean. They have an elegant, sculpted profile, plus they offer a two-sided color scheme, allowing you to have grilles that match not only the interior but also your exterior color choice.



**Finelight with Exterior Grilles** make interior glass easier to clean, while permanent exterior grilles provide architectural style and detail.

For an authentic look, **Full Divided Lights** feature permanently applied grilles to the interior and exterior of the window with a spacer between the glass.

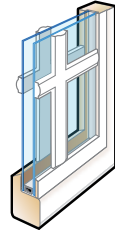
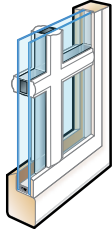

**Simulated Divided Lights** offer permanent grilles on the exterior and interior with no spacer between the glass.



Colonial Modified Colonial Prairie A Short Fractional



Tall Fractional Victorian Renaissance\* Sunburst\*

### SPECIFIED EQUAL LIGHT

Any number of same-size rectangles across or down. Some limitations apply.



(2 x 1) (1 x 3) (2 x 2) (2 x 4)

# COLOR

Choose the right color to enhance the beauty of your home, inside and out.

## EXTERIOR COLORS

Andersen® 100 Series products come in six exterior colors, including Black, Dark Bronze and Cocoa Bean — colors that are darker and richer than most vinyl windows.



## INTERIOR COLORS

100 Series products feature an attractive matte finish inside. This gives you the ability to select your favorite exterior color without compromising options for interior decoration.

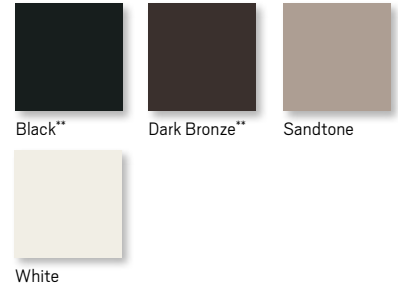

# HARDWARE

You get attractive hardware that performs reliably for years!†

## WINDOW HARDWARE



**Single-hung and gliding windows** feature hardware that automatically locks when windows are closed. Hardware color matches the window's interior.



Optional single-hung lift/pull handle matches the window's interior.



Optional metal Slim Line hardware is available in White, Sandtone, Dark Bronze, Black, Satin Nickel and Antique Brass.

**Casement and awning** hardware folds down so it doesn't interfere with window treatments and is available in White, Sandtone, Dark Bronze, Black, Satin Nickel and Antique Brass.



## GLIDING PATIO DOOR HARDWARE

Tulsa hardware exterior handles match the door's exterior color, while interior handles match the interior. Afton hardware has the same finish inside and out. Also available, an optional auxiliary foot lock that secures the gliding panel in the track. It provides an extra measure of security when the door is in a locked position.

### TULSA HARDWARE (Standard)

Exterior Handle

Interior Handle

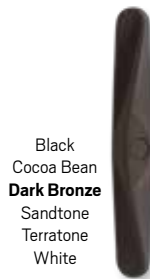

Black  
Cocoa Bean  
**Dark Bronze**  
Sandtone  
Terratone  
White

Black  
Dark Bronze  
Sandtone  
**White**

### AFTON HARDWARE (Optional)

Exterior Handle

Interior Handle



Antique Brass  
Black  
Bright Brass  
**Satin Nickel**

*Bold name indicates finish shown.*

\*Renaissance and Sunburst patterns are only available with Finelight grilles. \*\*Black and Dark Bronze interiors are only available with Black and Dark Bronze exteriors respectively. †Visit [andersenwindows.com/warranty](http://andersenwindows.com/warranty) for details. Printing limitations prevent exact color duplication. See your Andersen dealer for actual color samples.

# IMPROVING THE VIEW OUTSIDE.

## Respect for the environment is nothing new at Andersen.

For more than a century, it's been part of who we are. Our commitment to recycle and reclaim materials began simply because it was good business. Now it's part of our commitment to sustainability and responsible stewardship of all our resources. Andersen Corporation is committed to providing you with long-lasting, energy-efficient windows and doors.



Andersen makes windows and doors with options that achieve **ENERGY STAR® 6.0** certification throughout the United States.



Andersen is a charter member of the **U.S. Green Building Council** and a strong supporter of its LEED® (Leadership in Energy and Environmental Design) Green Building Rating System.



Andersen was the first window and door manufacturer with **Green Seal™** certified products. Please visit our web site at [www.andersenwindows.com](http://www.andersenwindows.com) for a list of certified products.

## DON'T JUST TAKE OUR WORD FOR IT



Check out these customer testimonials at [myAWstory.com](http://myAWstory.com)



10% POST CONSUMER RECYCLED FIBER

WINDOWS • DOORS  
**Andersen**® 

*Come home to Andersen.*®

[andersenwindows.com/100series](http://andersenwindows.com/100series)

Printed on FSC® certified paper, produced using Green-e certified renewable energy, with 10% post consumer recovered fiber.

"ENERGY STAR" is a registered trademark of the U.S. Environmental Protection Agency. All trademarks where denoted are marks of their respective owners. ©2016 Andersen Corporation. All rights reserved. 12/16 Part #9122169